

**Legend**

- Extent of Local Development Plan
- Retaining Walls (by developer)
- R20 Subject Lots
- R30 Subject Lots
- R40 Subject Lots
- Designated Garage Location
- Primary Frontage
- Secondary Frontage

**Location Plan**

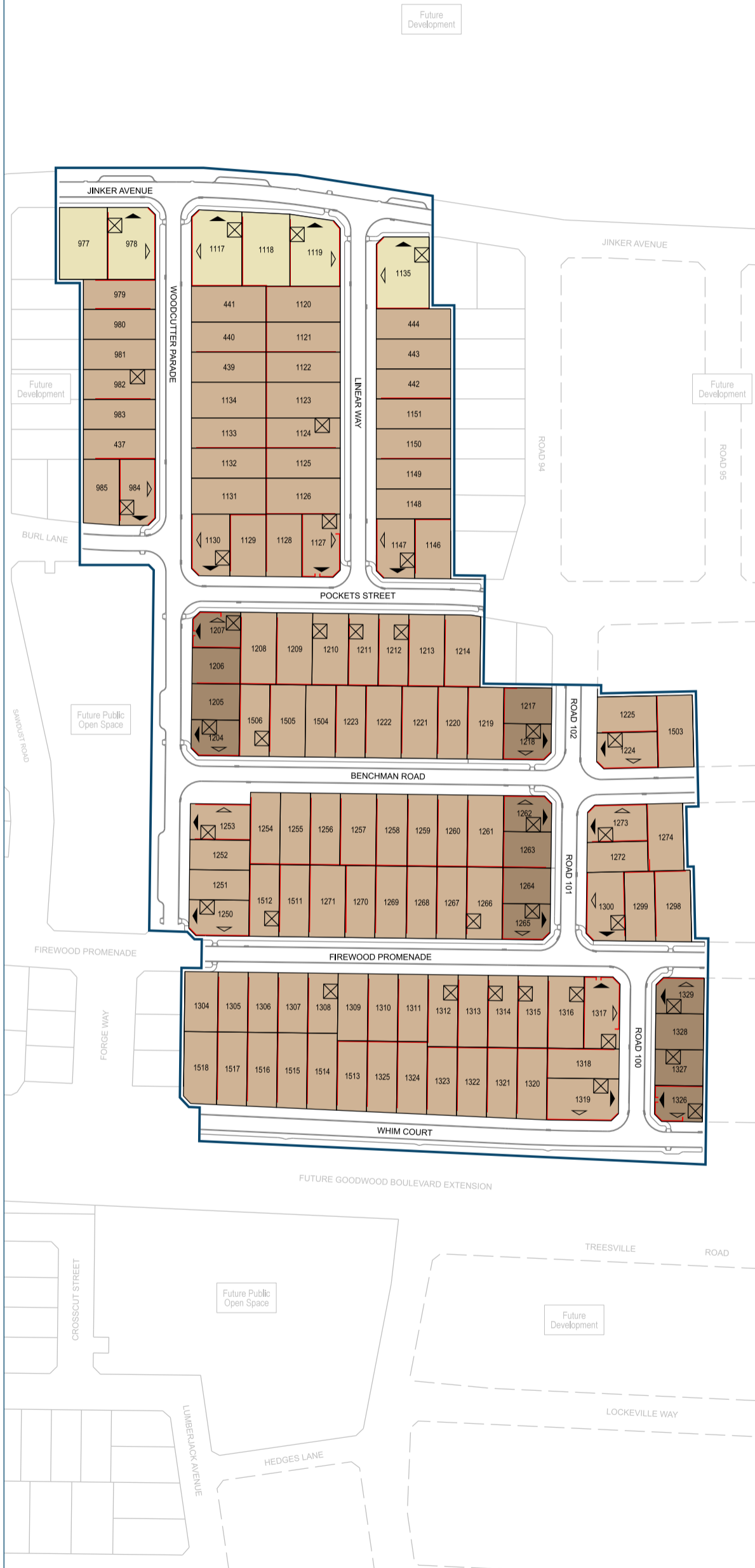

**Local Development Plan R-Code Variations**

**1 SCHEME AND RESIDENTIAL DESIGN CODE VARIATIONS**

- 1.1 The provisions of the Shire of Serpentine Jarrahdale Local Planning Scheme No. 3, Residential Design Codes Volume 1 (R-Codes) and Local Planning Policy 2.2: Residential Development Standards (R25-R60) are varied as detailed within this Local Development Plan (LDP).
- 1.2 All other requirements of the Local Planning Scheme No. 3 and R-Codes shall be satisfied in all other matters.
- 1.3 The erection or extension of a single house on a lot contained within this LDP, which satisfies the requirement of this LDP, is exempt from the requirement to obtain development approval.

**2 VISUAL AMENITY AND STREETScape REQUIREMENTS**

- 2.1 Dwellings on corner lots must address both primary and secondary streets. The secondary street facade must include a 4.5m return with detail matching the primary street elevation (i.e. colours, materials, windows, eaves detailing), and a major opening to a habitable room.
- 2.2 Front fencing within the primary street setback area is to be a maximum height of 900mm above natural ground level, measured from the dwelling side of the front fence. Fencing for the 4.5m secondary street return on corner lots must be visually permeable above 900mm.
- 2.3 For corner lots less than 16.0m in width (Lots 984, 1204, 1218, 1224, 1250, 1253, 1262, 1265, 1273, 1300 and 1329), where access is proposed from the primary frontage, dwellings may be setback up to 2.5m behind the garage provided that a portico, verandah or other entry feature, not less than 2.5m wide, is proposed within 750mm of the building line of the garage.
- 2.4 Primary dwelling access is to be taken from the frontage defined by the frontage orientation depicted on the plan.

**Endorsement Table:**

Local Development Plan approved pursuant to Schedule 2, Part 6, cl. 52 of the Planning and Development (Local Planning Schemes) Regulations 2015

Authorised Officer: m.legrange

Date: 30 April 2026

**TBB Planning**  
 Level 7, 160 St Georges Terrace  
 Perth WA 6000  
 T (08) 9226 4276  
 E admin@tbbplanning.com.au  
 tbbplanning.com.au

**Scale**  
 1:2000@A3  
 1:1000@A1

**Date**  
 28/04/2026

**Plan**  
 24/024/069D

**Drawn**  
 JB

**Grid**  
 PCG 94

**Approved**  
 ED



**Local Development Plan -  
 Stages 5G & 5H - (LDP 25)**

WHITBY TOWN  
 A Golden Group Project

