

DETAILED AREA PLAN R-CODE VARIATIONS

R-CODING

- The R40 Residential Density Code applies to all lots identified within the extent of this plan.
- All lots coded R40 on this plan have grouped dwelling potential. Please note that separate Detailed Area Plans provisions apply to these lots if single dwellings are to be constructed (refer Stage 6B DAP Sheet 1). When these lots are developed for grouped dwellings, the provision of this Detailed Area Plan shall prevail.

TOWN PLANNING SCHEME NO.2 AND RESIDENTIAL DESIGN CODE VARIATIONS

- Town Planning Scheme No.2 and Residential Design Codes are varied as described in these notations.
- The requirements of Town Planning Scheme No.2 and Residential Design Codes shall be satisfied in all other matters.

DESIGN ELEMENTS

- The following matters apply to the development of lots affected by the Detailed Area Plan:
 - All dwellings and garages (including patios and gazebos) must be constructed within the nominated building envelope;
 - At least one major opening to an indoor living area is encouraged to be installed on the northern elevation of a dwelling in order to maximise passive solar penetration.
 - No solid dividing fencing shall be permitted forward of the established building line.
 - All dwellings abutting POS shall be suitably designed and orientated to ensure passive surveillance of the POS. Dwellings shall have one or more major openings to a habitable room and an outdoor living area facing the POS.
 - Clothes lines and rubbish bin storage must be screened from the public view.
 - The minimum open space requirement is 40%.

SETBACKS

- Setbacks for development shall be in accordance with the following (except where noted, all other setbacks shall be in accordance with R-Codes):

R40

- Primary Street setback: Minimum 3m setback to dwelling
Maximum 6m setback to dwelling
- Public Open Space setback: Minimum 3m setback to ground floor of dwelling
Maximum 6m setback to ground floor of dwelling
Minimum 6m setback to upper storey of dwelling

GARAGES AND ACCESS

- Vehicle access to all dwellings must be provided from a common vehicle accessway. No garages are permitted fronting or siding the Primary Street.
 - All vehicle accessways and crossovers shall be brick paved or other suitable material (but not asphalt) to the satisfaction of the Shire and Developer.
 - For all lots, no adjoining landowner consultation is required where garages are built with a nil side setback.

FENCING

- All fencing within the estate will be provided and installed by the Developer. No additional fencing (other than side return panels) shall be erected without consultation and approval of the Developer. In the exceptional circumstance that front fencing is permitted, it shall be erected in accordance with the Developer's specific requirements.
 - All side boundary fencing behind the front building line is to be 1.8 metres high and fully installed prior to occupation of the dwelling.

NOTIFICATION TO PROSPECTIVE PURCHASERS

- The Developer is required to give prospective purchasers a complete copy of all the requirements of this Detailed Area Plan prior to Offer and Acceptance being made.

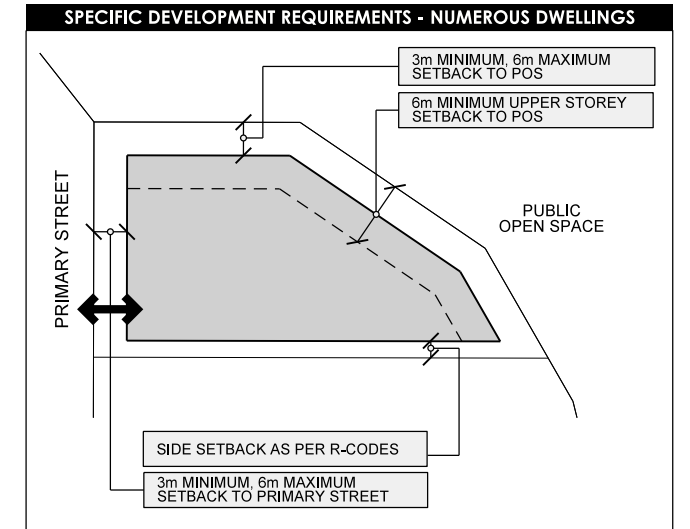
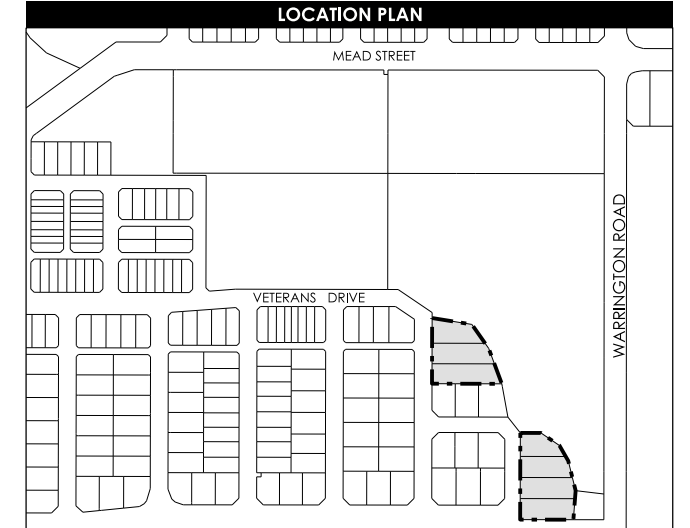
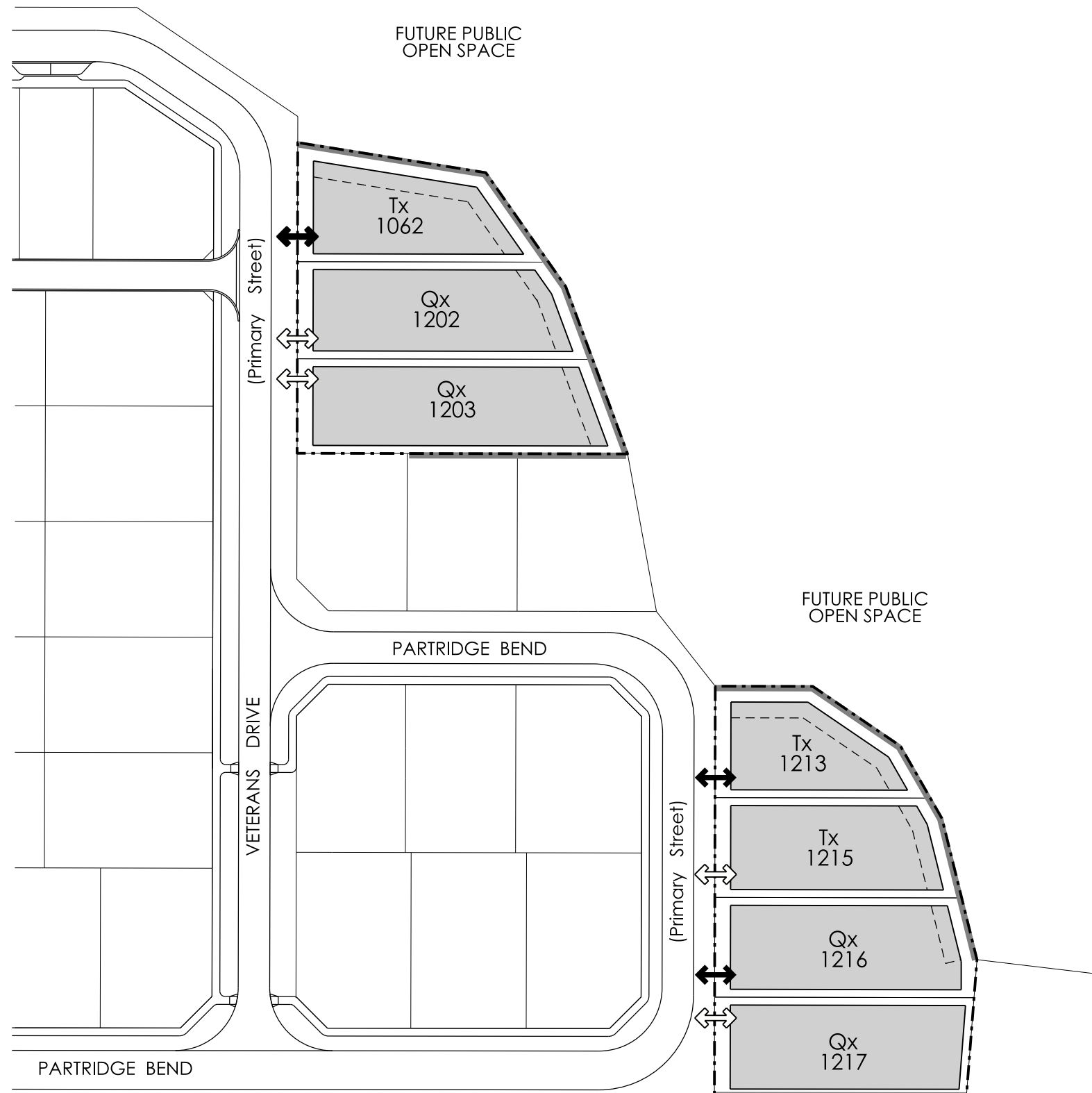

ENDORSEMENT TABLE	
Detailed Area Plan approved pursuant to Cl 5.18.5.1 (c) of Town Planning Scheme No.2	
Authorised officer	Date
	10/09/12

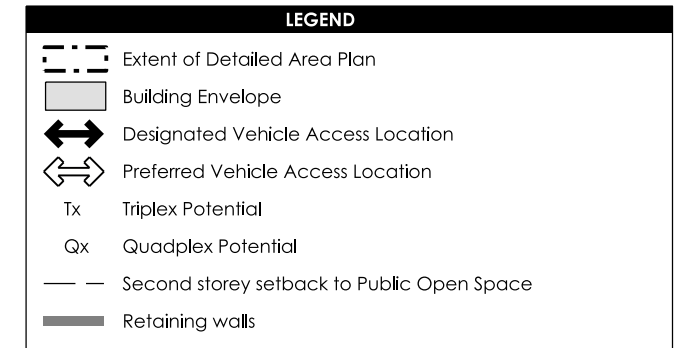

Detailed Area Plan - Stage 6B (Sheet 2 of 2 - Grouped Dwellings) (WAPC Ref: 145332)

THE GLADES, BYFORD
AN LWP BYFORD SYNDICATE PTY LTD PROJECT

Plan: 06/014/0738
 Date: 04/07/2012
 PCG 94
 Designed: JC
 Checked: BDM
 Drawn: YH
 Scale: 1:1000 @ A3
 0 10 20m
 Taylor Burrell Barnett Town Planning & Design
 187 Roberts Road Subiaco, Western Australia 6008
 p: (08) 9382 2911 f: (08) 9382 4586 e: admin@tbbplanning.com.au
 © COPYRIGHT TAYLOR BURRELL BARNETT. ALL RIGHTS RESERVED. NO PART OF THIS DOCUMENT MAY BE REPRODUCED IN ANY FORM OR BY ANY MEANS, ELECTRONIC, MECHANICAL, PHOTOCOPIING, RECORDING OR BY ANY INFORMATION STORAGE AND RETRIEVAL SYSTEM WITHOUT THE WRITTEN PERMISSION OF TAYLOR BURRELL BARNETT. ALL AREAS AND DIMENSIONS DISPLAYED ARE SUBJECT TO FINAL SURVEY.