

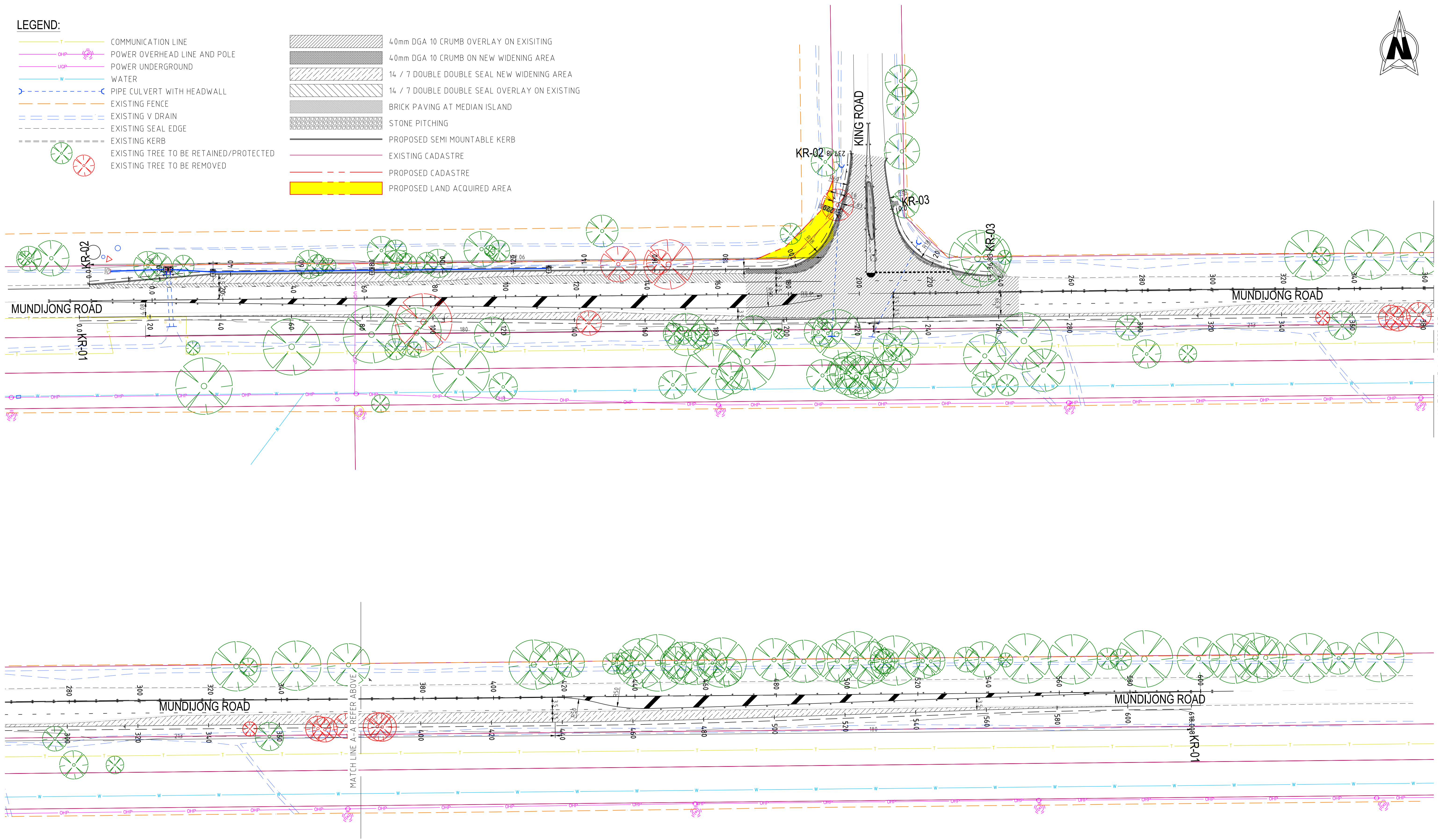

LEGEND:

- COMMUNICATION LINE
- POWER OVERHEAD LINE AND POLE
- POWER UNDERGROUND
- WATER
- PIPE CULVERT WITH HEADWALL
- EXISTING FENCE
- EXISTING V DRAIN
- EXISTING SEAL EDGE
- EXISTING KERB
- EXISTING TREE TO BE RETAINED/PROTECTED
- EXISTING TREE TO BE REMOVED
- 40mm DGA 10 CRUMB OVERLAY ON EXISTING
- 40mm DGA 10 CRUMB ON NEW WIDENING AREA
- 14 / 7 DOUBLE DOUBLE SEAL NEW WIDENING AREA
- 14 / 7 DOUBLE DOUBLE SEAL OVERLAY ON EXISTING
- BRICK PAVING AT MEDIAN ISLAND
- STONE PITCHING
- PROPOSED SEMI MOUNTABLE KERB
- EXISTING CADASTRE
- PROPOSED CADASTRE
- PROPOSED LAND ACQUIRED AREA



MATCH LINE A-A REFER BELOW

MATCH LINE A-A REFER ABOVE



Amendments	No	Date	Description	By	Approved
	0	07/11/2023	ISSUED FOR CONSTRUCTION	V.B	N.S

Scale: 1:500 @ A1
Datum: AHD - MGA ZONE 50



THIS DRAWING REMAINS THE PROPERTY OF THE SHIRE OF SERPENTINE JARRAHDAL AND SHALL NOT BE RETAINED, COPIED OR USED, WITHOUT WRITTEN APPROVAL FROM THE DIRECTOR ENGINEERING SERVICES

Drawn: B.V	Date: 18/07/23	Signet:
Designed: B.V	Date: 18/07/23	Signet:
Checked: B.V	Date: 28/08/23	Signet:
Manager Engineering Services:		

Project:	MUNDIJONG ROAD - KING ROAD INTERSECTION UPGRADE	Synergy No:	
Title:	GENERAL ARRANGEMENT	Revision No:	0
		Sheet No:	1 OF 1
		DWG No:	22-08-R03